

Technical Detail

Manufacturing Std : BS:5352
 Testing & Inspection Std : API:598 / BS-6755 (Part-I)
 Socket Weld Ends & S/E : As per ANSI B 16.11 & ANSI B 1:20:1

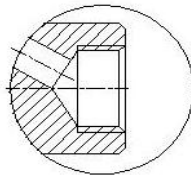

Screwed End Connection

Special Features

- With Electrical Actuator
- With Stelling
- With IBR Certification
- With Nace MR 0175

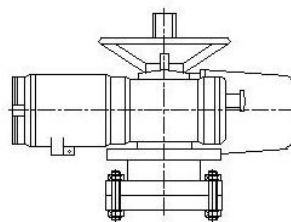

Electrical Actuator

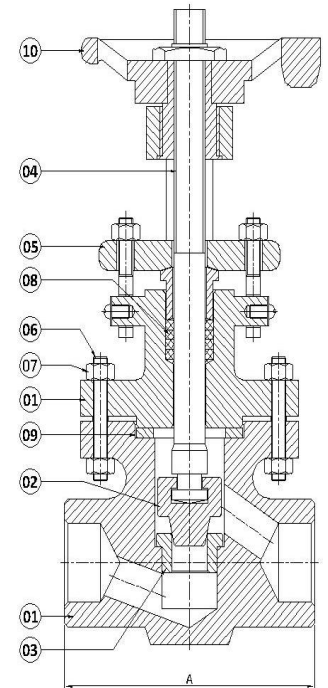

Material Detail

Part No.	Part Name	A 105	LF2	LF3	F304	F316	F11	F22
01	Body & Bonnet	ASTM A 105	A350 Gr. LF2	A350 Gr. LF3	A 182 Gr. F304	A 182 Gr. F316	A 182 Gr. F11	A 182 Gr. F22
02	Disc	ASTM A 105	A350 Gr. LF2	A350 Gr. LF3	A 182 Gr. F304	A 182 Gr. F316	A 182 Gr. F11	A 182 Gr. F22
03	Seat Ring	A 182 Gr.F6a	A 182 Gr.F6a	A 182 Gr.F6a	A276-304	A276-316	A276-410	A276-410
04	Stem	A276-410	A276-410	A276-410	A276-304	A276-316	A276-410	A276-410
05	Gland Flange	A 216 WCB	A 216 WCB	A 216 WCB	A351Gr.CF8	A351Gr.CF8M	A 216 WCB	A 216 WCB
06	Bolts	A193 B7	A320 L7	A320 L7	A193 B8	A193 B8	A193 B16	A193 B16
07	Nuts	A193 B7	A320 L7	A320 L7	A193 B8	A193 B8	A193 B16	A193 B16
08	Packing	Graphoil Rings						
09	Gasket	S.S.304 / S.S.316 Spiral wound Gasket with Grafoil Filler						
10	Hand Wheel	Ductile or Malleable Iron						

Also Available

1. Casting in WCC,LCC,CF3,CF8C,CN7M, Hastalloy, Monel also Provided against Requirement
2. Trim Material
3. Special Features Like Stelling

Primary Service Rating & Test Pressure

Class	Hyd. Test Pressure	
	Body	Seat
800	3000 PSIG	2000 PSIG
1500	5400 PSIG	4000 PSIG
2500	9000 PSIG	6600 PSIG
Air Test - Seat	80 PSIG ±10 PSIG	